

# MWOM600 Standard Carcase

**Vertical Lift Hinge Mechanism**  
( VERL600 - using 600 wide carcase )  
Maximum Microwave Dimensions  
Width 513mm  
Height 385mm  
Depth 433mm

## Component List

- 1 x 6TEBM-RH
- 1 x 6TEBM-LH
- 2 x 6T6
- 1 x 5T6
- 2 x 3T6
- 1 x BWM6
- 1 x BWA6
- 1 x BWL6
- 1 x R6

## Other Components to go with MWOM600

- 2 x 347H x 297W Doors
- 1 x 448H x 597W Microwave Flap (Optional)
- 2 x 283H x 597W Drawer Fronts
- 1 x Bag LEGM4 or (LEGP4)
- 1 VERL600 Lift up Hinge (Optional)
- 2 x DRM150G1/600 Metabox Drawers or ( 2 x MDD6 )
- 4 x H107 Hinges & Plates
- 5 x Handles with Microwave Flap Option

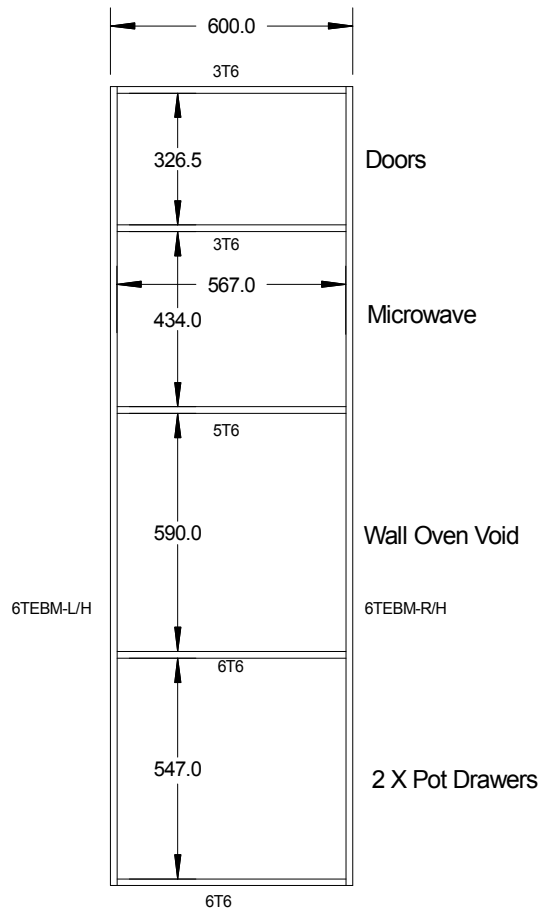

Front Elevation

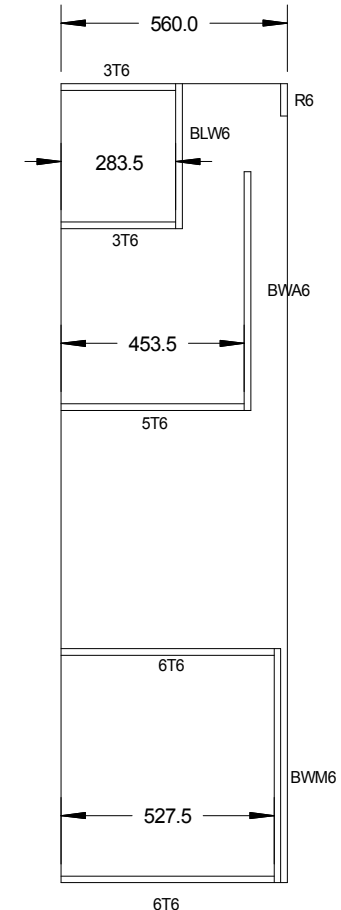

End Elevation



ABN : 16 108 210 902

Proform is constantly seeking ways to improve the specification, design & production of its products, and alterations take place occasionally. Whilst every effort is made to produce up to date literature, this instruction sheet should not be regarded as an infalible guide to specifications, we recommend that the prospective purchaser ensures that our catalogue identifies the product displayed or described herein.

Proform Products Pty Ltd Tel:(08)9209 6200 Fax:(08) 9209 6222 Website: [www.proform.com.au](http://www.proform.com.au)

MWOM600 Sheet - R 20/05/04